

DTCM118-56-AL

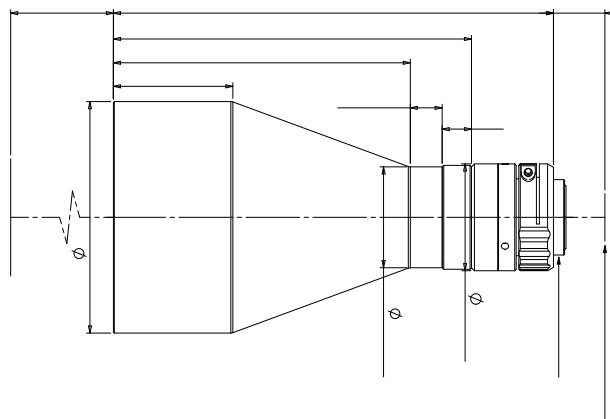

-
- FOV 26mm 300mm
- 1/2.5" ~ 1.1" C
-

FOV(mm)	56
(x)	0.161
WD(mm)	138±3
CCD (mm)	9.0(1/1.8")
F/#	4.6
MTF30 (lp/mm)	>190
DoF(mm)	±17.0@F11
(% max)	<0.1
(° max)	<0.1
I/O(mm)	306±3

DTCL-56-xW-y

56mm



(mm x mm)

	C
(mm)	149.9
(kg)	0.7

1/1.8" IMX178 (7.43x4.9)	46.1x30.4
1/1.8" IMX252/265 (7.1x5.3)	44.1x32.9